

# Removal and Installation instructions for Statim® 2000/5000 cassette seal

- 1.** The cassette must be removed from the machine and opened before removing the gasket. (see Picture 1)



- 2.** Open and separate the cassette. Place the side of the cassette with the seal on a flat surface so that it can easily be worked on freeing your hands to install the seal. (see. picture 2)



- 3.** Start with any of the (4) corners and begin removing the cassette seal. We recommend using a gasket removing tool (ID-SCSTOOL) Do not poke the seal directly. Position tool between gasket and tray. Begin removing the cassette seal by pulling down and out at the same time until the entire seal is removed from the cassette housing. (see picture 3)



- 4.** After the cassette seal is removed, it is critical to inspect-clean and remove any residue in the cassette housing groove. Make sure there are no dings and or dents in the cassette housing groove that might cause the seal to leak steam. (see picture 4) Throw the old seal away so as not to confuse it with the new one.

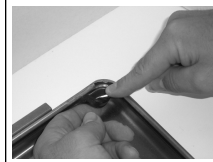

- 5.** With the new seal in hand, lubricate the outer edge that will come into contact with the cassette housing groove (ID-SCSLUBE). This allows the seal to be positioned easier in the cassette housing. It is not necessary to lubricate the inside edges. (see picture 5)

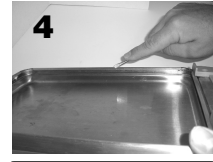

- 6.** Now install the cassette seal by placing the seal in the back corners first so the TWO HOLES LINE UP BETWEEN THE GASKET AND CASSETTE TRAY. (This is a critical sep so as to avoid installing the seal incorrectly) (see picture 6)

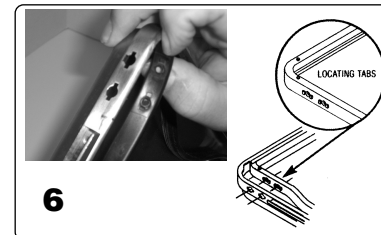

- 7.** Continue installing each of the (4) corners making sure that the two locating tabs are at the edge of the lip on the cassette tray. (see picture 7)



- 8.** After each of the (4) comers are in place, continue installing the cassette seal into the groove (first the top and then the bottom) making sure the corners are still located correctly and the locating tabs are still properly visible. (see picture 8) If the tabs are not located properly, repeat step 7. After the seal is installed completely and correctly, inspect the final installation. (see picture 9)

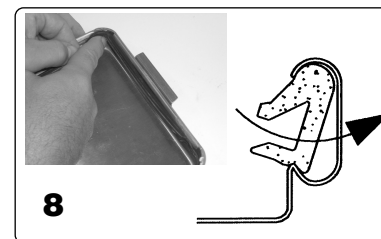

- 9.** Remove any soap/residue from the holes in the cassette. This could cause leakage if not clean. (see picture 10)



- 10.** Cycle the unit for steam leaks and insure pressurization. Note: During the test cycles it is normal to hear a hissing sound at first. The sound is from the excess soap expelling and the cassette seal seating in the metal cassette housing tray



- 11.** After running the cycles, if steam leaks or pressurization does not occur, it is possible that the seal has been damaged during installation, improperly installed, or there is another problem. Contact your service representative and refer to the owner's manual.

**InsoDentally**  
Incidentals for the Health Care Industry

<b>East Coast</b>	<b>West Coast</b>
InsoDentally	InsoDentally Corporate
8686 Lindberg Blvd.	2935-C East Patrick Lane
Olmsted Falls, OH 44138	Las Vegas, NV 89120

(440) 243-4904 • [www.insodentally.com](http://www.insodentally.com)